

# Beatbox 24

Portable speaker

## Operation manual



IP20 EAC RoHS



### 1. Functions

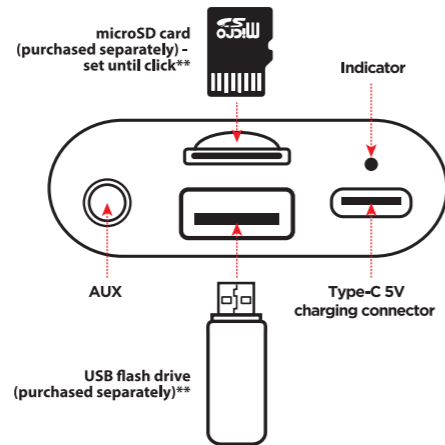
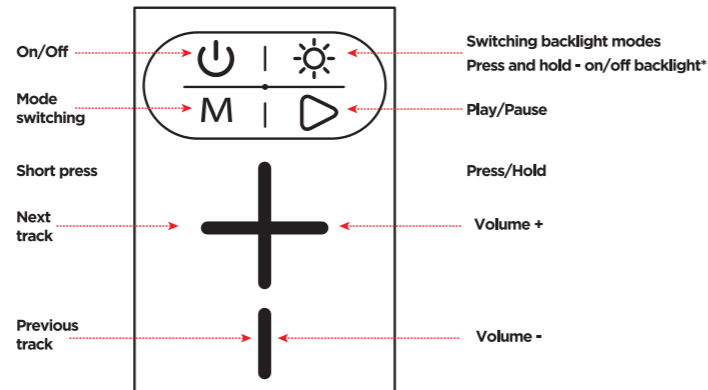

\*When the speaker is operating with backlight, a small background sound is possible, which can be heard in absolute silence, if this bothers you, turn off the backlight by pressing and holding the backlight key

\*\*The flash drive (USB, microSD) must be up to 32 GB in size and formatted in FAT32

### 2. Charging

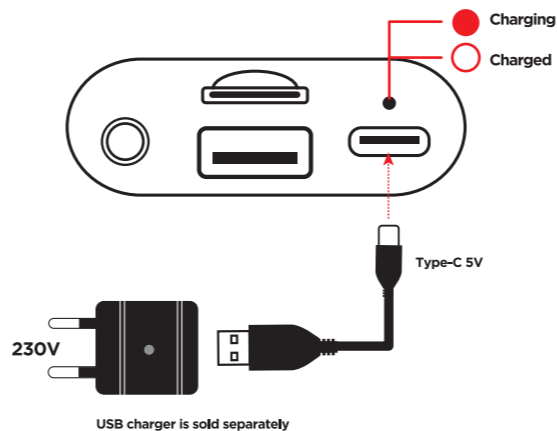

### 3. Bluetooth connection

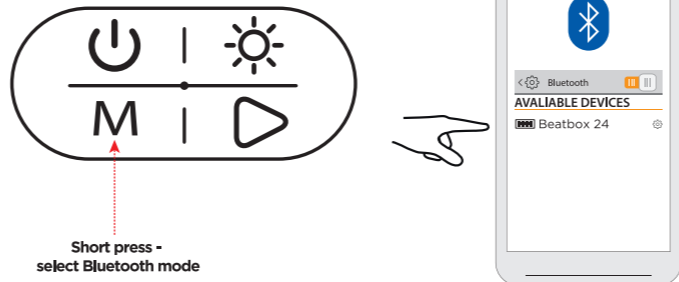

### 4. Stereo system of two Beatboxes 24 (TWS mode)

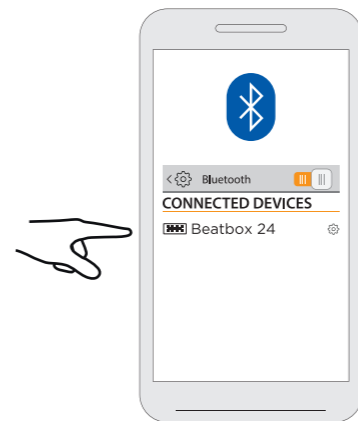
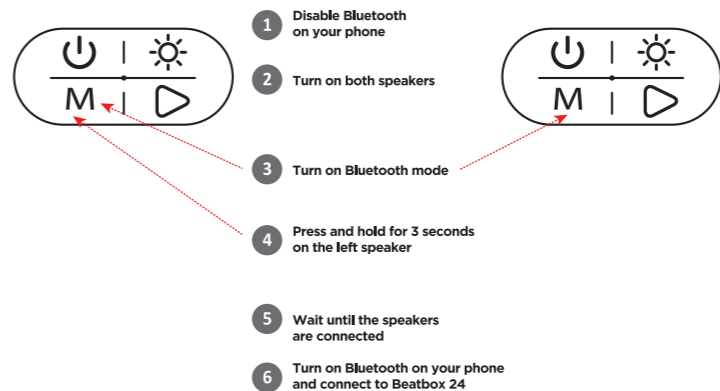

### 5. AUX playback

